

- Grass and Wildflower Seeding Mixes**
- Mix A**
Grass and Wildflower Seeding Mix at 25g/m²
Festuca rubra (Slender Creeping Red Fescue) 30%
Lolium perenne (Perennial Ryegrass) 25%
Poa pratensis (Smooth Stalked Meadow-grass) 20%
Agrostis castellanii (Highland Bent) 20%
Triticum repens (Small Leaved White Clover) 5%
- Mix B**
Species Rich Neutral Grassland Seed Mix at 5g/m²
Cynodon dactylon (Crested Dogtail) 16%
Festuca rubra (Slender Creeping Red Fescue) 15%
Agris capillaris (Common Bent) 10.5%
Dactylis glomerata (Cocksfoot) 10.5%
Agrostis pratensis (Meadow Foxtail) 5.5%
Deschampsia cespitosa (Tufted Hair-grass) 5.5%
Tetradlea flavescens (Yellow Oak-Grass) 5.5%
Poa pratensis (Smooth-Stalked Meadow Grass) 5%
Ranunculus acris (Meadow Buttercup) 3%
Achillea millefolium (Common Yarrow) 2%
Centaurea nigra (Common Knopweed) 2%
Pimpinella lancofolia (Ribwort Thistle) 2%
Ranunculus repens (Creeping Buttercup) 2%
Ranunculus flammula (Yellow Rattle) 2%
Ammannium odoratum (Sweet Vernal Grass) 1%
Centaurea scaberrima (Greater Knopweed) 1%
Lactuca scariola (Black Lettuce) 1%
Pimpinella vulgaris (Pepper Thistle) 1%
Purshia villosa (Sedhead) 1%
- Mix C**
Marsh, Waddy Grassland and Fen Seed Mix at 5g/m²
Achillea ptarmica (Sedgewort) 1%
Agrostis capillaris (Common Bent) 12%
Ammannium odoratum (Sweet Vernal-grass) 1%
Achillea millefolium (Yarrow) 0.5%
Bidens tripartita - (Starry orchids) Beary 0.4 %
Centaurea nigra (Common Knopweed) 1%
Cynodon dactylon (Crested Dogtail) 32%
Pimpinella vulgaris (Pepper Thistle) 1%
Festuca rubra (Red Fescue) 25% 0.2%
Festuca ovina (Sheep Fescue) 0.2%
Galium aparine (Lamb Balm) 8%
Helianthus annuus (Yellow Flg) 1%
Leucanthemum vulgare (Great Daisy) 1.5%
Lolium perenne (Perennial Ryegrass) 1%
Lythrum salicaria (Purple loosestrife) 1%
Pimpinella lancofolia (Ribwort Thistle) 1%
Primula verna (Cowslip) 1%
Ranunculus acris (Meadow Buttercup) 3%
Ranunculus minor (Yellow Rattle) 1.6%
Rumex acetosella (Common Sorrel) 1.2%
Sanguisorba officinalis (Great Burnet) 0.5%
Silene alba (Peppercor) 1%
Silene flaccida - (Lychins fls-coral) (Ragwort Rain) 0.3%
Silene elica - (Red Campion) 1%
Succisa pratensis (Devil's-bit Scabious) 0.4%
Vicia cracca (Tufted Vetch) 2%
- Seed Mix D**
Improved Grassland Seed Mix sown at 4 g/m²
Agrostis castellanii (Highland Bent) 3%
Cynodon dactylon (Crested Dogtail) 9%
Dactylis glomerata (Cocksfoot) 9%
Festuca rubra (Slender Creeping Red-fescue) 12%
Lolium perenne (Perennial Ryegrass) 35%
Ptilium bedfordii (Smaller Cat-tail) 6%
Poa pratensis (Smooth-stalked Meadow-grass) 9%
Schedonorus pratensis (Meadow Fescue) 12%
Triticum repens (Small Leaved White Clover) 3%

FOR CONTINUATION,
 SEE DRAWING NO. 0006

FOR CONTINUATION,
 SEE DRAWING NO. 0012

FOR CONTINUATION,
 SEE DRAWING NO. 0008

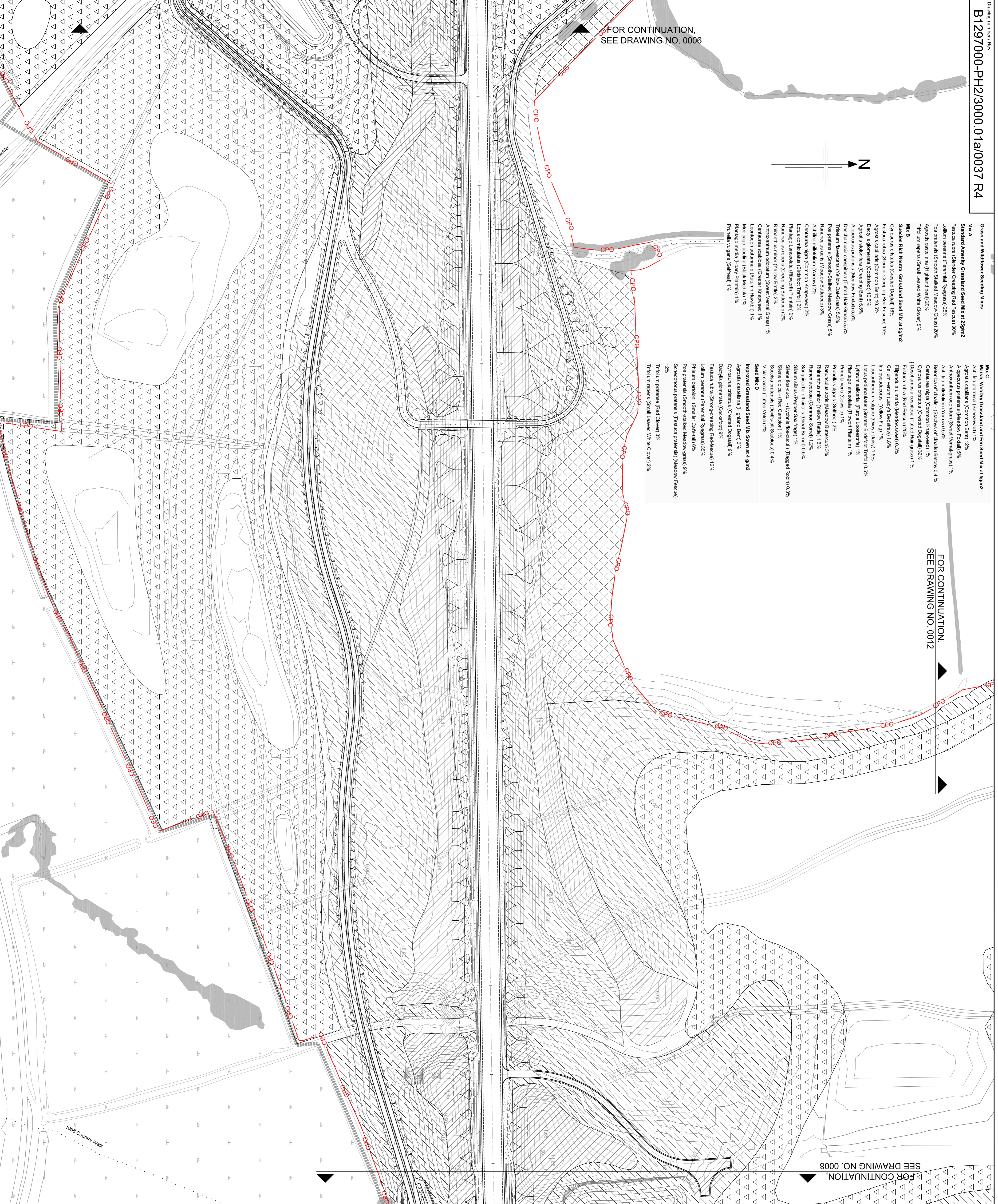

- NOTES**
- All dimensions in metres unless otherwise stated.

- KEY**
- Mix A (Standard amenity grass seed mix)
 - Mix D (Arable)
 - Mix B (Species rich neutral grassland)
 - Mix C (Open grassland suitable for halcyon foraging)
 - Mix C (Marsh, wet grassland and fen)
 - Mix D (Improved grassland)
 - 75mm deep composted bark mulch
 - Site of Special Scientific Interest (SSSI)
 - Site of Nature Conservation Importance (SNCI)
 - Ditch
 - Watercourse
 - Pond
 - Public Footpath
 - Byway
 - Railway
 - Existing trees to be retained
 - Finished ground within planting plots but outside the specified working area to be retained
 - Existing trees to be retained

SAFETY, HEALTH AND ENVIRONMENTAL INFORMATION

In addition to the hazards normally associated with the types of work detailed on this drawing, note the following:

CONSTRUCTION
 Likelihood of 4th-degree hazardous substances
 Existing overhead and underground high voltage cables
 Working adjacent to a railway
 Working on slopes steeper than 1:3
 Working near to site plant and other machinery

MAINTENANCE / CLEANING
 Same as for construction

DECOMMISSIONING / DEMOLITION
 Same as for construction

It is assumed that all works will be carried out by competent contractor working, where appropriate, to an approved method statement.

Reproduction from the Ordnance Survey Map with the permission of the controller of Her Majesty's stationery office Crown copyright reserved Licence No. AL 100017326

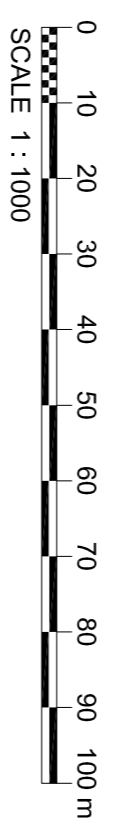

Rev	Rev. Date	Purpose of revision	Drawn	Checked	Rev'd	Apprv'd
R4	08/03/2013	EA ACCESS AMENDED	LC	AS	RHS	RBD
R3	28/02/2013	GREENWAY AMENDED AT HILLCROFT	ASC	RNS	SSG	RBD
R2	08/01/2013	PLANTING SEEDING REMOVED	EH	AS	AS	AB
R1	13/12/2012	CHANGES TO SEED MIXES	AS	ES	ES	AB
R0	18/10/2012	INITIAL ISSUE	RM	ES	AS	AB

JACOBS
 Simpson Hill, 6 Cherry Orchard Road, Gordon, Surrey, CR9 6BE
 Tel: +44(0)208 666 8212 Fax: +44(0)208 661 2499
 www.jacobs.com

HOCHTIEF
 Infrastructure
 www.hochtief.com

TRV
 www.trv.com

ecobio
 www.ecobio.com

BEXHILL TO HASTINGS LINK ROAD

SEEDING
 SHEET 7 OF 13

ISSUE FOR REVIEW
 DO NOT SCALE

Drawing status

Scale 1:1000 @ A1
 Jacobs No. B1297000
 Client no. B1297000
 Drawing number B1297000-PH2/3000.01a/0037
 Rev R4

This drawing is not to be used in whole or part other than for the intended purpose and project as defined on this drawing. Refer to the contract for full terms and conditions.